

Eco-Logic™  
Permaculture & Landscape Design

# Pizza Permaculture

A Starter Workshop  
based on the  
Grow By Chunking principle

The concept for this workshop is to present a small-scale, intensive project that introduces people with no experience to Permaculture in an easy, inexpensive, & productive way that can be the starting point for site development.

## Permaculture Principles In Action

- Observe over time & design for specific site & client.** Susanna & Matt have lived at Ujima for years & have been able to witness & cooperate with site microclimates, as well as weave the pizza garden in with other design elements, namely the cob oven.
- "Start small with intensive & productive systems that are manageable."** The design is for a very small overall area, but inside it much is happening. From soil layering to mycoremediation, the pizza garden allows for growth by chunking.
- Obtain a yield.** Herbs will continually produce, and so will mushrooms. Plants like Basil and tomatoes are fun to plant each year and widely available. Giant zucchini can be shared with neighbors or provide potluck dishes to help Ujima continue to build community.
- Connect using relative location.** We've placed the pizza garden in useful relationship to the wildlife tree bench, firepit, and cob oven. This means being able to walk between all of these areas, carry produce fresh-picked from the garden to the oven's prep counter, and sit comfortably on the bench and around the firepit.
- Use biological & renewable resources.** Donated plants & organic compost & mulches, & volunteer design & labor contribute to social as well as natural capital, or the long-term establishment of beneficial relationships & stored energy.
- Turn problems into solutions.** When we recognized that the beds had been sited 12" too close to the bench in an effort to give room for firepit seating, we were able to plan for narrowing the bench around the wildlife tree as well as move the beds out. This solved the problem of people not being able to lean back against the tree before when sitting on the bench.

\*paraphrased by Tom Ward



*Stropharia rugoso annulata*  
(Wine Caps King Stropharia)  
Companion Planting  
- Jordan Weiss

- Scrape to bare clayey ground - dig in with a shovel & mix in wood chip matrix to spread future humus layer.
- Mix in the chips (6 months old Alder, Maple, Birch, Cottonwood, Ash = no more than 20% of pile) with pure mushroom spawn.
- Compost layer on top of wood chips with hole for plants. Acid-loving plants, heavy feeders, and mulch plants work best.
- Layer with 70% wet cardboard - cut hole for each plant & insert into woodchip matrix.
- Dress with compost, freshly wetted straw, or other practically free resource.

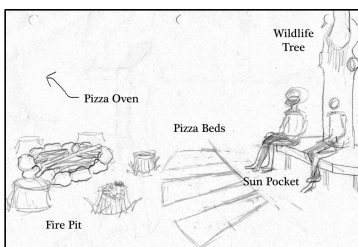

## Design Team

Mushrooms - Jordan Weiss  
Landscape & Document  
Design - Jadene Mayla  
mycotree@yahoo.com  
jadene@ecologiclandscape.com

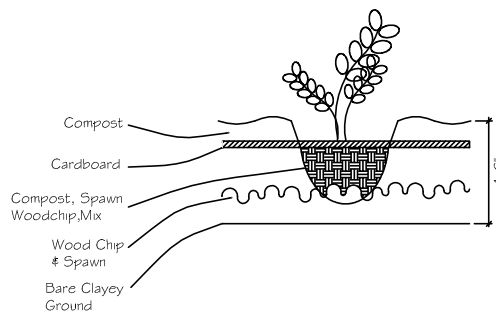
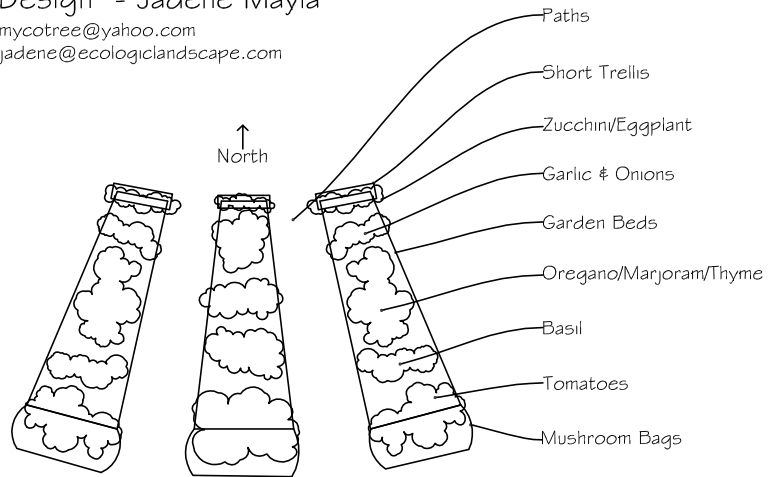

## Design Considerations

- Sun exposure needs for the plants differ from that of the mushrooms, so Jadene sited the tomatoes next to the mushroom crusts (burlap bags containing spawn & growing medium at the tops of the beds) without the use of cages. This allows the tomatoes to drape over the burlap bags and shade the spawn inside, creating a microclimate.
- Proximity to the cob oven makes it easy for Susanna, Matt, and their guests to bring fresh toppings to the prep area when the dough is ready.
- Leaving adequate space for movement around fire pit seats and the wildlife tree bench ensures a welcoming and comfortable space as well as a functional garden.
- Narrowing paths between beds allows for such a small garden to inhabit this special sun-drenched spot amidst other activities and gardens.
- Visually linking the garden to pizza via shaping the beds like slices is a fun way to key potential users into the social side of Permaculture.

## Materials List

- \* organic compost
- \* 3 tomato plants
- \* 1 oregano plant
- \* 1 thyme plant (or tarragon)
- \* 3 basil plants
- \* 1 zucchini plant
- \* 1 eggplant plant
- \* 1 head of garlic
- \* 1 marjoram plant
- \* bale of fresh straw
- \* 1 simple wood trellis, cut into 3 equal pieces
- \* mushroom bundle
- \* cardboard
- \* wood chips



Image Source [http://t2.gstatic.com/images?q=tbn:ANd9GcRYm-ZG2-WGkyO9qJCIFy35R\\_zEM9Tz100fMT7ngogBQbaVYQhZ](http://t2.gstatic.com/images?q=tbn:ANd9GcRYm-ZG2-WGkyO9qJCIFy35R_zEM9Tz100fMT7ngogBQbaVYQhZ)